

**Grand Californian  
Anaheim, California  
2001**

Owner: Walt Disney Imagineering  
Architect: Urban Design Group  
Contractor: Turner Construction  
EOR: Gregory P. Luth

**Description**

The complex craftsman style architecture of Disney's Grand Californian in earthquake country posed many intensive structural design challenges.



**Statistics**

- 1,000,000 sq. ft. PT slabs in 7 wings
- Complex architectural forms
- Conference center
- 60-foot wide, 7-story atrium spanned with 10-inch deep steel 3 hinged offset arch

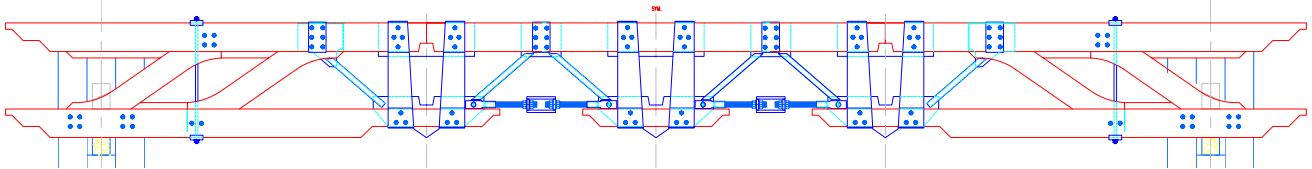
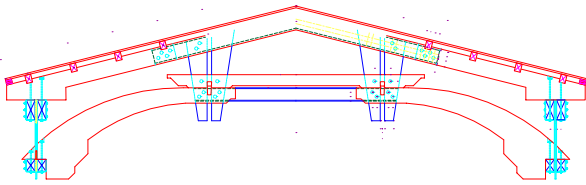

**Heavy Timber Porte Cochere Trusses**

Meticulously crafted structural detail drawings for the heavy timber porte cochere trusses.

